

## CABLE LUG

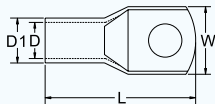

Terminal material: Copper



ITEM NO.	Stud Size	DIMENSION				WIRE SIZE	
		W	L	D	D1	AWG	DIN mm <sup>2</sup>
C2.5-5	5.3	8.0	18.0	2.7	3.9	16-14	2.5
C4-5	5.3	10.0	20.0	3.0	4.5	12-10	4
C6-5	5.3	10.0	23.0	4.0	5.5	12-10	6
C10-6	6.4	10.0	25.0	4.5	6.2	#8	10
C10-8	8.4	12.6	25.0	4.5	6.2		
C16-6	6.4	10.0	30.0	5.4	7.1	#6	16
C16-8	8.4	12.6	30.0	5.4	7.1		
C25-6	6.4	12.6	35.0	6.8	8.8	#4	25
C25-8	8.4	12.6	35.0	6.8	8.8		
C25-10	10.5	15.0	35.0	6.8	8.8	#2	35
C35-6	6.4	15.0	38.0	8.4	10.6		
C35-8	8.4	15.0	38.0	8.4	10.6		
C35-10	10.5	15.0	38.0	8.4	10.6		
C50-8	8.4	18.0	43.0	9.7	12.4	1/0	50
C50-10	10.5	18.0	43.0	9.7	12.4		
C50-12	13.0	18.0	43.0	9.7	12.4	2/0	70
C70-8	8.4	21.0	50.0	11.8	14.7		
C70-10	10.5	21.0	50.0	11.8	14.7		
C70-12	13.0	21.0	50.0	11.8	14.7		
C95-10	10.5	25.5	58.0	14.2	17.4	3/0	95
C95-12	13.0	25.5	58.0	14.2	17.4		
C120-10	10.5	28.0	60.0	15.7	19.4	4/0	120
C120-12	13.0	28.0	60.0	15.7	19.4		
C120-14	15.0	28.0	60.0	15.7	19.4	300MCM	150
C120-16	17.0	28.0	60.0	15.7	19.4		
C150-12	13.0	30.5	69.0	17.2	21.2	350MCM	185
C150-14	15.0	30.5	69.0	17.2	21.2		
C150-16	17.0	30.5	69.0	17.2	21.2	500MCM	240
C185-12	13.0	34.0	78.0	19.2	23.5		
C185-14	15.0	34.0	78.0	19.2	23.5		
C185-16	17.0	34.0	78.0	19.2	23.5	600MCM	300
C240-10	10.5	38.5	92.0	21.7	26.5		
C240-12	13.0	38.5	92.0	21.7	26.5		
C240-14	15.0	38.5	92.0	21.7	26.5		
C240-16	17.0	38.5	92.0	21.7	26.5		
C240-18	19.0	38.5	92.0	21.7	26.5	800MCM	400
C300-12	13.0	43.5	101.0	24.5	30.0		
C300-14	15.0	43.5	101.0	24.5	30.0		
C300-16	17.0	43.5	101.0	24.5	30.0	1000MCM	500
C400-14	15.0	53.0	114.0	29.5	36.5		
C400-16	17.0	53.0	114.0	29.5	36.5		
C400-18	19.0	53.0	114.0	29.5	36.5	-	630
C500-14	15.0	56.0	124.0	31.0	39.0		
C500-16	17.0	56.0	124.0	31.0	39.0		
C500-18	19.0	56.0	124.0	31.0	39.0	-	800
C630-20	21.0	63.5	130.0	35.0	44.0		
C800-20	21.0	73.0	140.0	40.0	50.0		

## CABLE LUG-HIGH VOLTAGE



Terminal material: Copper

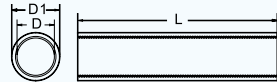

Tolerance: ±2mm

ITEM NO.	DIMENSION			WIRE SIZE	
	L	D	D1	AWG	DIN mm <sup>2</sup>
BL-8	52	4.0	6.2	#8	10
BL-14	50	6.0	8.8	#6	16
BL-22	55	7.7	10.5	#4	25
BL-38	64	9.8	12.4	#2	35
BL-60	71	11.0	14.0	1/0	50
BL-80	75	13.1	16.0	3/0	70
BL-100	75	14.0	18.0	4/0	95
BL-125	87	15.6	20.0	4/0	120
BL-150	95	17.0	22.0	300MCM	150
BL-180	98	18.2	23.0	350MCM	185
BL-200	105	20.0	25.8	400MCM	240
BL-250	115	22.0	28.2	500MCM	240
BL-325	120	24.2	32.0	600MCM	300
BL-400	130	29.3	36.3	800MCM	400
BL-500	150	31.0	40.0	1000MCM	500

## CROSS-REFERNECE OF WIRE RANGE

Sq	AWG	Drahtgrobereich mm <sup>2</sup>	DIN Querschnitt mm <sup>2</sup>
(Taiwan/Japan)	(America)	(England)	(Germany)
0.5	26-2	0.1-0.4	0.14/0.20/ 0.25/0.36
1.25	22-16	0.4-1.0	0.5/0.75/1.0
2	16-14	1.1-2.6	1.5-2.5
2	16-14HD	1.1-2.6	1.5-2.5
5.5	12-10	2.7-6.6	4-6
8	8	6.7-10.5	10
14	6	10.6-16.7	16
22	4	16.8-26.6	25
38	2	26.7-42.4	35
60	1/0	42.5-60.5	50
70	2/0	60.6-76.2	70
80	3/0	76.3-97.0	95
100	4/0	98.0-120	120
150	250-300 MCM	121-151	150
180	300-350 MCM	152-192	185
200	400MCM	193-242	240
325	500-600 MCM	243-304	300