

RING TERMINAL

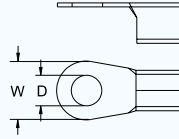

Terminal material: Copper



SQ SERIES

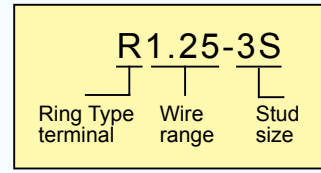
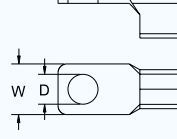

ITEM NO.	Stud Size	Width	WIRE SIZE			
	D(mm)	W(mm)	AWG	DIN mm ²		
R1.25-3S	3.2	5.5	22-16	0.5-1.0		
R1.25-3	3.7	5.5				
R1.25-4	4.3	8.0				
R1.25-4M	4.3	6.6				
R1.25-5	5.3	8.0				
R1.25-6	6.4	11.7				
R1.25-8	8.4	11.7				
R1.25-10	10.5	13.7				
R2-3S	3.2	6.5			16-14	1.5-2.5
R2-3	3.7	6.5				
R2-4	4.3	8.5				
R2-4M	4.3	6.6				
R2-5	5.3	9.5				
R2-6	6.4	12.0				
R2-8	8.4	12.0				
R2-10	10.5	13.6				
R3.5-4	4.3	8.0	14-12	2.5-4		
R3.5-5	5.3	8.0				
R3.5-6	6.4	12.0				
R3.5-8	8.4	15.0				
R3.5-10	10.5	15.0				
R5.5-4	4.3	9.5	12-10	4-6		
R5.5-5	5.3	9.5				
R5.5-6S	6.4	12.0				
R5.5-6	6.4	12.0				
R5.5-8	8.4	15.0				
R5.5-10	10.5	15.0				
R5.5-12	13.0	19.3	8	10		
R8-4	4.3	12.0				
R8-5S	5.3	9.0				
R8-5	5.3	12.0				
R8-6	6.4	12.0				
R8-8	8.4	15.0				
R8-10	10.5	15.0				
R8-12	13.0	20.0			6	16
R14-5	5.3	9.5				
R14-6	6.4	12.0				
R14-8	8.4	16.0				
R14-10	10.5	16.0				
R14-12	13.0	22.0	4	25		
R22-6S	6.4	13.0				
R22-6	6.4	16.0				
R22-8S	8.4	13.0				
R22-8	8.4	16.5				
R22-10	10.5	16.5				
R22-12	13.0	22.0	2	35		
R30-8	8.4	16.5				
R30-10	10.5	16.5				
R38-6S	6.4	15.0				

ITEM NO.	Stud Size	Width	WIRE SIZE	
	D(mm)	W(mm)	AWG	DIN mm ²
R38-6ST	6.4	15.3	2	35
R38-6T	6.4	22.0		
R38-8S	8.4	15.0		
R38-8ST	8.4	15.3		
R38-8	8.4	18.5		
R38-8T	8.4	22.0		
R38-10S	10.5	15.0		
R38-10ST	10.5	15.3		
R38-10	10.5	18.5		
R38-10T	10.5	22.0		
R38-12	13.0	18.5	1/0	50
R38-12T	13.0	22.0		
R50-8SQ	8.4	16.0		
R50-10SQ	10.5	16.0		
R50-12	13.0	19.0		
R60-8	8.4	19.0		
R60-8SQ	8.4	17.3		
R60-10	10.5	19.0		
R60-10SQ	10.5	17.3		
R60-12	13.0	19.0		
R60-16L	17.0	32.0	4/0	120
R60-20L	21.0	32.0		
R80-8	8.4	22.0		
R80-8SQ	8.4	18.9		
R80-10	10.5	22.0		
R80-10SQ	10.5	18.9		
R80-12	13.0	22.0		
R80-12SQ	13.0	18.9		
R80-16L	17.0	32.0	250/300 mcm	150
R80-20L	21.0	32.0		
R80-22L	23.0	32.0		
R100-8	8.4	28.5		
R100-8SQ	8.4	23.0		
R100-10	10.5	28.5		
R100-10SQ	10.5	23.0		
R100-12	13.0	28.5		
R100-12SQ	13.0	23.0		
R100-16L	17.0	32.2		
R100-20L	21.0	32.2		
R100-22L	23.0	32.2		
R125-8SQ	8.4	23.0		
R125-10SQ	10.5	23.0		
R125-12SQ	13.0	23.0		
R150-10	10.5	36.5		
R150-10SQ	10.5	25.0		
R150-12	13.0	36.5		
R150-12SQ	13.0	25.0		
R150-16	17.0	36.5		
R150-16SQ	17.0	25.0		



RING TERMINAL



Terminal material: Copper

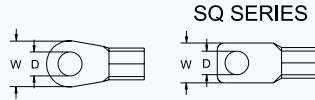

ITEM NO.	Stud Size	Width	WIRE SIZE			
	D(mm)	W(mm)	AWG	DIN mm ²		
R150-16L	17.0	36.5	250/300 mcm	150		
R150-20L	21.0	36.5				
R150-22L	23.0	36.5				
R150-24L	25.0	36.5				
R180-12SQ	13.0	28.0				
R180-16SQ	17.0	28.0				
R180-16L	17.0	39.0				
R180-20L	21.0	39.0				
R180-22L	23.0	39.0				
R180-24L	25.0	39.0				
R200-10	10.5	44.0			400 MCM	240
R200-10SQ	10.5	32.7				
R200-12	13.0	44.0				
R200-12SQ	13.0	32.7				
R200-16	17.0	44.0				
R200-16SQ	17.0	32.7				
R200-16L	17.0	44.0				
R200-20L	21.0	44.0				
R200-22L	23.0	44.0				
R200-24L	25.0	44.0				
R200-27L	28.0	44.0				
R250-10	10.5	44.0	400 MCM	240		
R250-10SQ	10.5	32.7				
R250-12	13.0	44.0				
R250-12SQ	13.0	32.7				
R250-16	17.0	44.0				
R250-16SQ	17.0	32.7				
R250-16L	17.0	44.0				
R250-20L	21.0	44.0				
R250-22L	23.0	44.0				
R250-24L	25.0	44.0				
R250-27L	28.0	44.0				
R325-10	10.5	51.0			500/600 MCM	300
R325-10SQ	10.5	38.4				
R325-12	13.0	51.0				
R325-12SQ	13.0	38.4				
R325-16	17.0	51.0				
R325-16SQ	17.0	38.4				
R325-16L	17.0	51.0				
R325-20L	21.0	51.0				
R325-22L	23.0	51.0				
R325-24L	25.0	51.0				
R325-27L	28.0	51.0				

Y TERMINAL



Terminal material: Copper

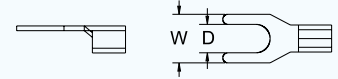

ITEM NO.	Stud Size	Width	WIRE SIZE			
	D(mm)	W(mm)	AWG	DIN mm ²		
Y1.25-3S	3.7	5.7	22-16	0.5-1.0		
Y1.25-3	3.7	6.2				
Y1.25-4	4.3	7.2				
Y1.25-4S	4.3	6.4				
Y1.25-5	5.3	8.0				
Y1.25-6	6.3	9.7				
Y2-3S	3.7	5.7	16-14	1.5-2.5		
Y2-3	3.7	6.2				
Y2-4S	4.2	6.5				
Y2-4	4.3	7.2				
Y2-5	5.3	8.0				
Y2-6	6.4	10.7				
Y3.5-3S	3.7	6.4	14-12	2.5-4		
Y3.5-3	3.7	7.4				
Y3.5-4	4.3	8.0				
Y3.5-5	5.3	8.0				
Y5.5-3S	3.7	7.2			12-10	4-6
Y5.5-3	3.7	8.2				
Y5.5-4S	4.3	7.2				
Y5.5-4	4.3	8.2				
Y5.5-5	5.3	9.0				
Y5.5-6	6.4	12.0				
Y8-4	4.3	8.2	8	10		
Y8-5	5.3	9.0				
Y8-6	6.4	12.0				
Y14-6	6.4	12.0	6	16		
Y22-8	8.4	13.0	4	25		

