

# 0607 KSS 电缆固定头转接头 REDUCTION GLAND

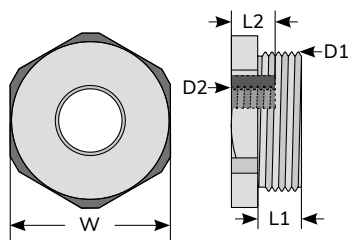

材质：UL合格之NYLON66，防火等级 94V-2。  
用途：此产品可将固定头的螺纹外径由小尺寸转换成大尺寸。



※标准色为黑色

单位：mm

| 型号<br>Item No. | 外螺纹规格 D1       |                        |                          |            | 内螺纹规格 D2       |            | 宽度<br>W | 包装<br>Packing |
|----------------|----------------|------------------------|--------------------------|------------|----------------|------------|---------|---------------|
|                | 螺纹规格<br>Thread | 螺纹外径<br>Thread<br>O.D. | 铁板孔径<br>Mounting<br>Hole | 螺纹长度<br>L1 | 螺纹规格<br>Thread | 螺纹长度<br>L2 |         |               |
| M2012          | M20X1.5        | 20                     | 20+0.2                   | 8.0        | M12X1.5        | 11.0       | 24.2    | 100pcs        |
| M2016          | M20X1.5        | 20                     | 20+0.2                   | 8.0        | M16X1.5        | 12.0       | 24.2    |               |
| M2516          | M25X1.5        | 25                     | 25+0.3                   | 8.0        | M16X1.5        | 13.0       | 29.0    |               |
| M2520          | M25X1.5        | 25                     | 25+0.3                   | 8.0        | M20X1.5        | 14.0       | 29.0    |               |
| M3220          | M32X1.5        | 32                     | 32+0.3                   | 10.0       | M20X1.5        | 14.5       | 35.9    | 50pcs         |
| M3225          | M32X1.5        | 32                     | 32+0.3                   | 10.0       | M25X1.5        | 15.0       | 35.9    |               |
| M4032          | M40X1.5        | 40                     | 40+0.3                   | 10.0       | M32X1.5        | 15.0       | 45.8    | 25pcs         |
| M5040          | M50X1.5        | 50                     | 50+0.3                   | 11.5       | M40X1.5        | 15.0       | 55.0    |               |
| M6350          | M63X1.5        | 63                     | 63+0.3                   | 11.5       | M50X1.5        | 11.5       | 67.5    |               |

※标准色为灰色

单位：mm

| 型号<br>Item No. | 外螺纹规格 D1       |                        |                          |            | 内螺纹规格 D2       |            | 宽度<br>W | 包装<br>Packing |
|----------------|----------------|------------------------|--------------------------|------------|----------------|------------|---------|---------------|
|                | 螺纹规格<br>Thread | 螺纹外径<br>Thread<br>O.D. | 铁板孔径<br>Mounting<br>Hole | 螺纹长度<br>L1 | 螺纹规格<br>Thread | 螺纹长度<br>L2 |         |               |
| M1612GY4       | M16X1.5        | 16                     | 16+0.2                   | 8.0        | M12X1.5        | 12.0       | 22.0    | 100pcs        |
| M2512GY4       | M25X1.5        | 25                     | 25+0.3                   | 8.0        | M12X1.5        | 13.0       | 28.5    |               |
| M3212GY4       | M32X1.5        | 32                     | 32+0.3                   | 10.0       | M12X1.5        | 10.0       | 35.5    | 50pcs         |
| M3216GY4       | M32X1.5        | 32                     | 32+0.3                   | 10.0       | M16X1.5        | 14.3       | 35.5    |               |
| M4016GY4       | M40X1.5        | 40                     | 40+0.3                   | 10.0       | M16X1.5        | 10.0       | 45.5    | 25pcs         |
| M4020GY4       | M40X1.5        | 40                     | 40+0.3                   | 10.0       | M20X1.5        | 10.0       | 45.5    |               |
| M4025GY4       | M40X1.5        | 40                     | 40+0.3                   | 10.0       | M25X1.5        | 10.0       | 45.5    |               |
| M5020GY4       | M50X1.5        | 50                     | 50+0.3                   | 12.0       | M20X1.5        | 12.0       | 54.5    |               |
| M5025GY4       | M50X1.5        | 50                     | 50+0.3                   | 12.0       | M25X1.5        | 12.0       | 54.5    |               |
| M5032GY4       | M50X1.5        | 50                     | 50+0.3                   | 12.0       | M32X1.5        | 12.0       | 54.5    |               |
| M6325GY4       | M63X1.5        | 63                     | 63+0.3                   | 12.0       | M25X1.5        | 12.0       | 67.5    |               |
| M6332GY4       | M63X1.5        | 63                     | 63+0.3                   | 12.0       | M32X1.5        | 12.0       | 67.5    |               |
| M6340GY4       | M63X1.5        | 63                     | 63+0.3                   | 12.0       | M40X1.5        | 12.0       | 67.5    |               |

配线槽

配线标志

扎线带

结束带

固定座

固定头、浪管

保护部品

接线头

套管

固定夹

PC板部品

扣具